

COLLEGE DRIVE

EDGE STREET 50' R/W (FORMERLY 5TH AVE.)

MULTI-STORY  
BRICK BUILDING  
F.F.E=111.47

PLANT STREET 50' R/W

ALABAMA STREET

FELTON AVENUE (FORMERLY 6TH AVE.)

FELTON AVENUE

SITE PLAN

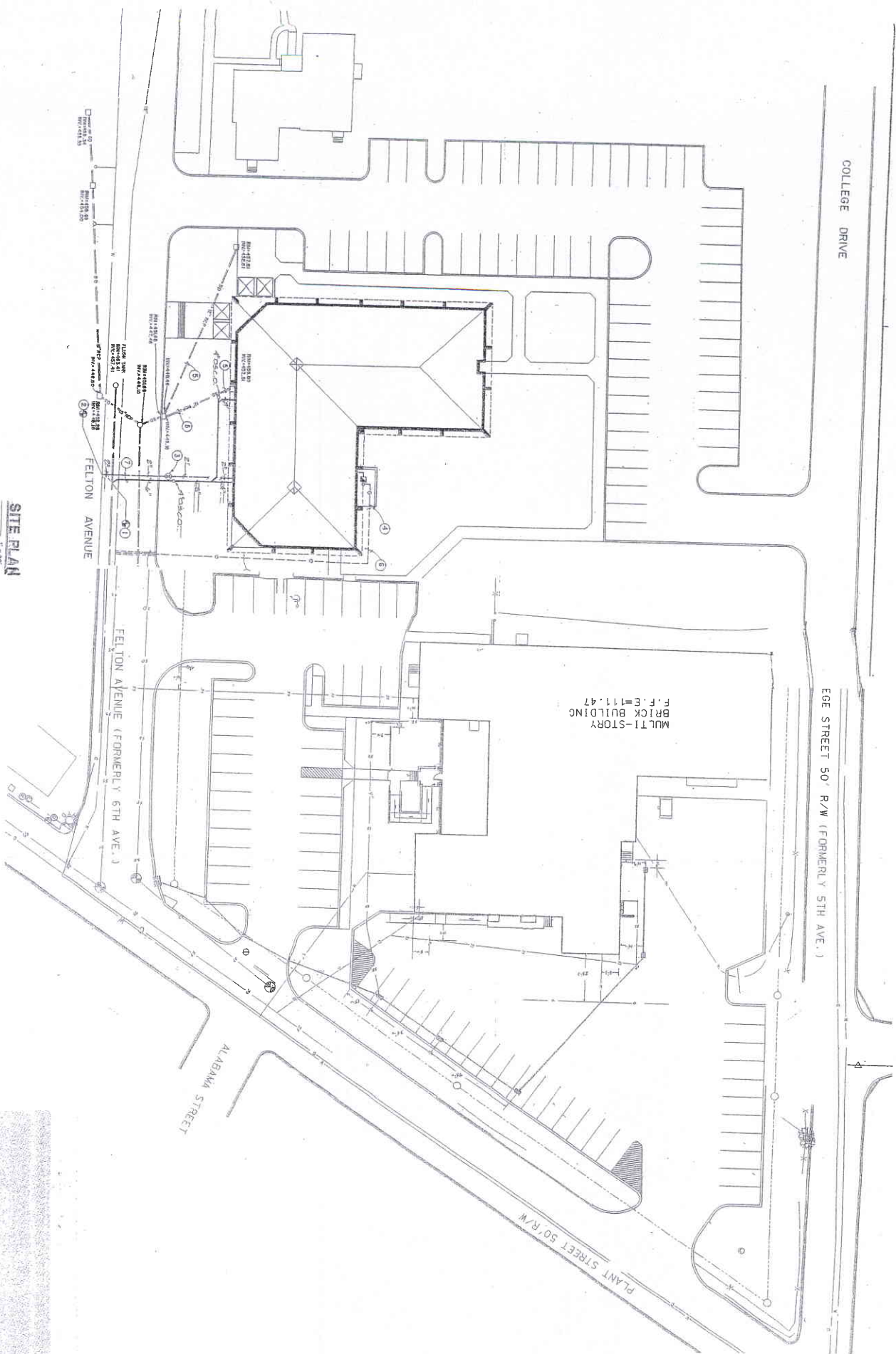

GA 7-2/2A TINDALL HEIGHTS

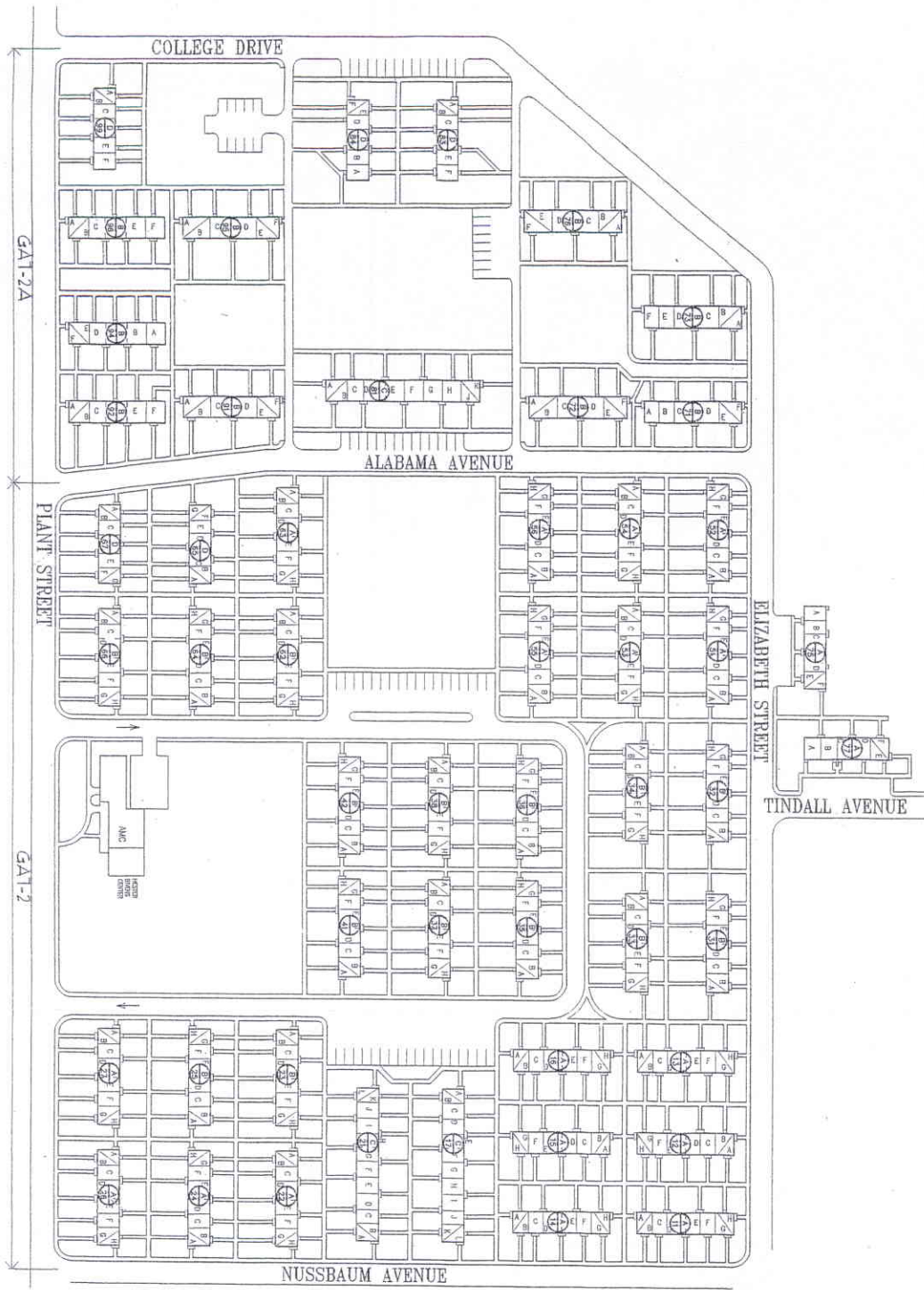

1705  
 PROJECTS BUILDING HITE  
 INDICATES BUILDING HITE  
 INDICATES UNIT ADDRESS

LEGEND

TH-50

HENRY A. CORSINI, AIA · ASID  
 ARCHITECT, INC.  
 GEORGE S. RUTTER AIA, ASSOCIATE  
 MACON, GEORGIA

SITE REFERENCE PLANS  
 THE HOUSING AUTHORITY OF THE CITY OF MACON, GEORGIA

PROJECT GA7-2/2A TINDALL HEIGHTS  
 SITE PLAN, SITE LOCATION MAP,  
 AND TABULATION OF BUILDING  
 UNITS